

T ECHNICAL INFORMATION



PRODUCT

P 1 / 11

Models No. ▶ KP0810, KP0810C

Description ▶ Power Planer 82mm (3-1/4")

CONCEPT AND MAIN APPLICATIONS

Model KP0810 features the following user-friendly advantages:

- *Left and right chip ejection for convenience
- *Precise planing depth setting by adjustment dial with click stops and easy-to-read scale with 0.1mm divisions
- *Front base with 3 chamfering grooves
- *Shiplapping Cuts: up to 25mm (1")

Model KP0810C additionally features the followings:

- *Electronic with soft start and constant speed control
- *Powerful 1,050 W motor

These products are available in the following variations.

KP0810/ KP0810C	without Plastic carrying case
KP0810K/ KP0810CK	with Plastic carrying case

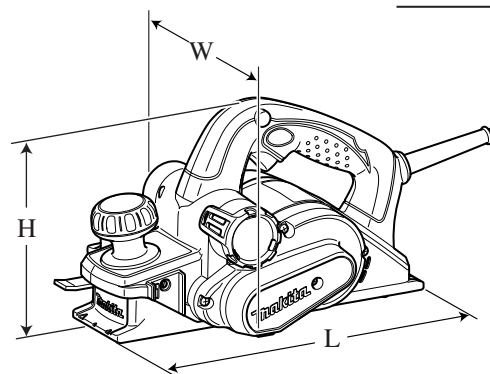

Dimensions: mm (")	
Length (L)	290 (11-3/8)
Width (W)	168 (6-5/8)
Height (H)	176 (6-15/16)

► Specification

Voltage (V)	Current (A)		Cycle (Hz)	Continuous Rating (W)			Max. Output (W)	
	KP0810	KP0810C		Input		Output	KP0810	KP0810C
110	8.1	11	50/60	850	1,050	500	900	1,200
120	7.5	10	50/60	---	---	500	900	1,200
220	4.1	6	50/60	850	1,050	500	900	1,700
230	3.9	6	50/60	850	1,050	500	900	1,700
240	3.7	6	50/60	850	1,050	500	900	1,700

Model No.		KP0810	KP0810C
No load speed: min-1=rpm		16,000	12,000
Capacities: mm (")	Planing width	82 (3-1/4)	
	Planing depth	4 (5/32)	
	Shiplapping	25 (1)	
Electronic features	Soft start	No	Yes
	Constant speed control	No	Yes
Protection against electric shock		Double insulation	
Power supply cord: m (ft)		*2.5 (8.2)	
Net weight: kg (lbs)		3.2 (7.2)	3.3 (7.3)

*2.0m (6.6ft) for Australia, 4.0m (13.1ft) for Germany

► Standard equipment

- Blade gauge assembly
- Depth guide
- Guide rule
- Socket wrench 9
- Planer blade (re-sharpenable type) or T.C.T. Mini planer blade
- Sharpening holder assembly (for countries using re-sharpenable type Planer blade)
- Dust bag (UK only)
- Plastic carrying case (for KP0810K/KP0810CK)

Note: The standard equipment for the tool shown above may differ by country.

► Optional accessories

- | | |
|----------------------------|------------------------------------|
| Guide rule | Planer blade (re-sharpenable type) |
| Chamfering rule assembly | T.C.T. Mini planer blade |
| Dust bag | Dressing stone |
| Sharpening holder assembly | Elbow |
| Blade gauge assembly | Plastic carrying case |

► **Repair**

CAUTION: Unplug the machine and remove the planer blade from the machine for safety before repair/ maintenance in accordance with the instruction manual!

CAUTION: Unplug the machine and remove the planer blade from the machine for safety Always wear gloves when handling the drum and the planer blade!

[1] NECESSARY REPAIRING TOOLS

Code No.	Description	Use for
1R045	Gear extractor (large)	Removing Drum from Bracket complete
1R263	Bearing extractor (2pcs required)	Lifting up Bracket when removing it from Housing
1R269	Bearing extractor	Removing Ball bearings from Armature
1R288	Screwdriver magnetizer	Magnetizing Screwdriver for removing Steel ball 4 and Compression spring 3
1R291	Retaining ring S and R pliers	Removing Retaining ring S-10 from Drum holder complete
1R350	Ring 60 (2pcs required)	Holding the Machine when removing Bracket from Housing

[2] LUBRICATION

Apply Makita grease N. No.1 to the following portions designated with the black triangle to protect parts and product from unusual abrasion.

Item No.	Description	Portion to lubricate
⑤	Steel ball 4 (2 pcs)	Whole surface
⑥7	Front base complete	Hole for accepting Cam
		Edges on which Housing slides
⑥9	Leaf spring (2 pcs)	Surface that contacts Housing

Fig. 1

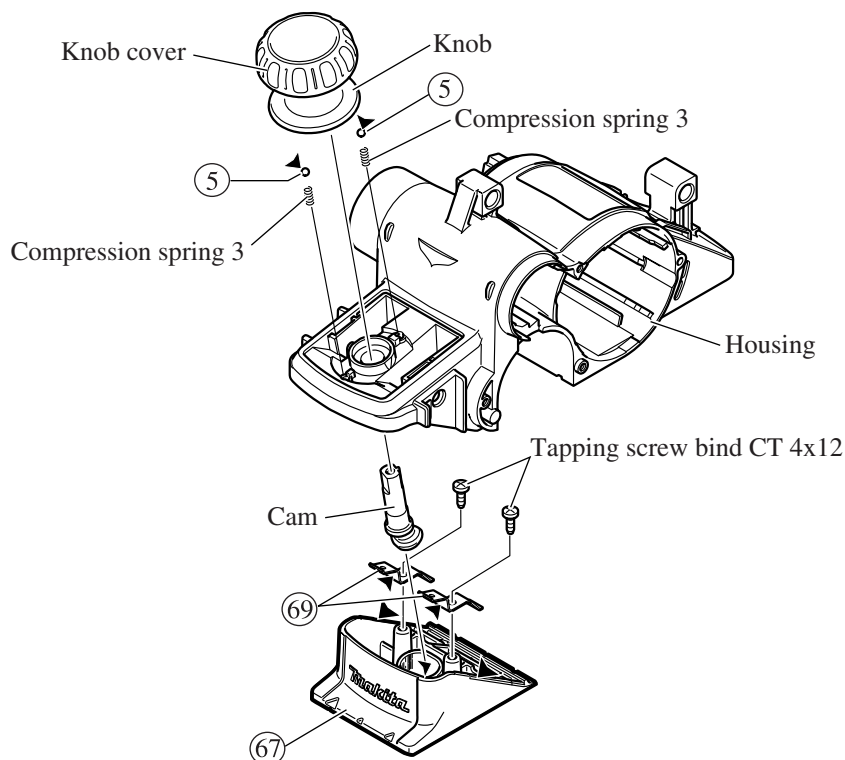

► **Repair**

[3] DISASSEMBLY/ASSEMBLY

[3] -1. Poly V-Belt

DISASSEMBLING

- 1) Put the machine on two 1R350's with Belt cover side up. (Fig. 2)
- 2) Remove Belt cover by unscrewing Pan head screw M4x18. Poly V-belt 4-241 can now be seen. (Fig. 3)

Fig. 2

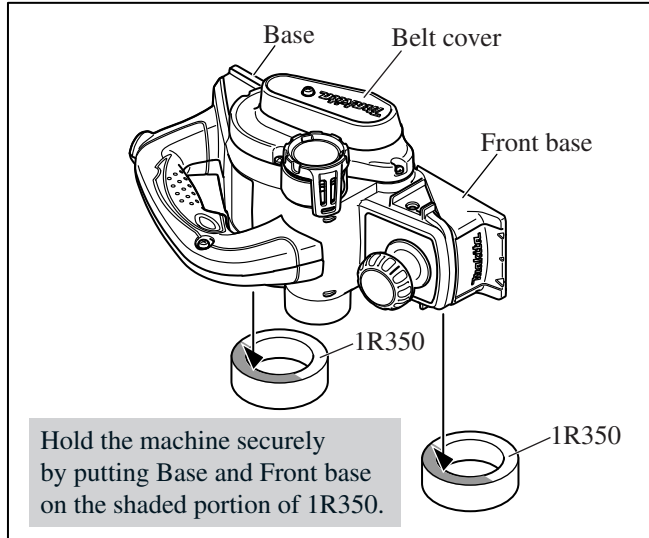
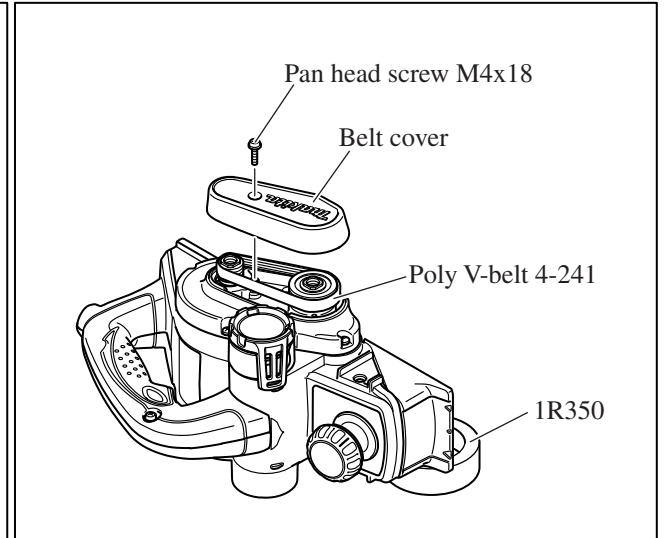
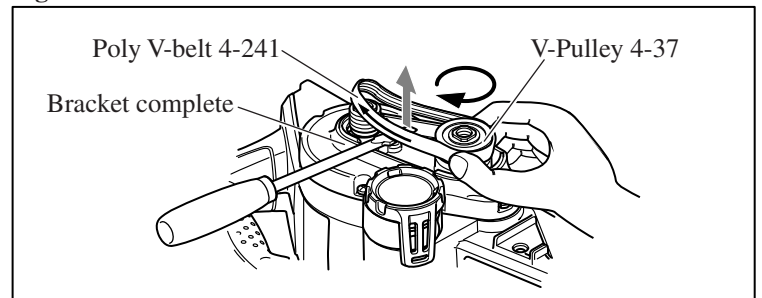

Fig. 3



- 3) If you replace Poly V-belt 4-241 with new one, remove it by cutting with nippers. If you reuse Poly V-belt 4-241 to be removed, remove it by following the steps below (Fig. 4):
 1. Insert a slotted screwdriver between Poly V-belt 4-241 and Bracket complete as illustrated in Fig. 4.
 2. While turning V-Pulley 4-37 (larger one) in the direction of the black arrow, lift up Poly V-belt 4-241 with the screwdriver.

Fig. 4



ASSEMBLING

Assemble Poly V-belt 4-241 to V-Pulley 4-20L (smaller one of the two V-Pulleys) as illustrated in Fig. 5 then to V-Pulley 4-37 (larger one) as in Fig. 6. Then assemble Belt cover to Bracket complete. (Refer to Fig. 3)

Fig. 5

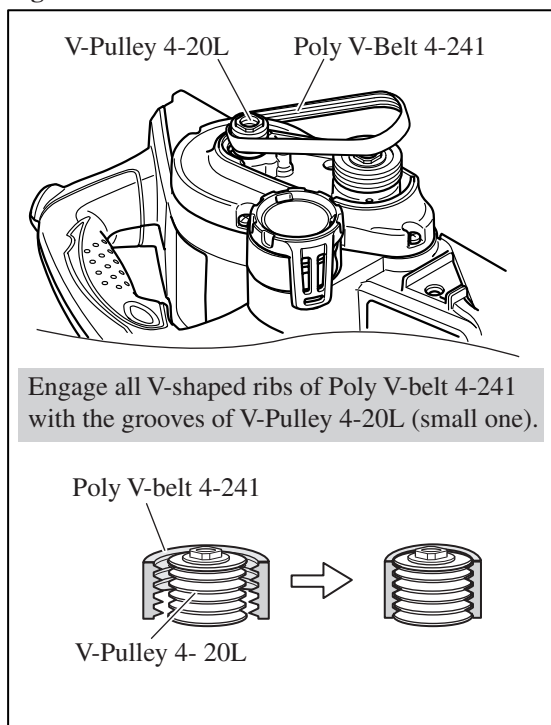
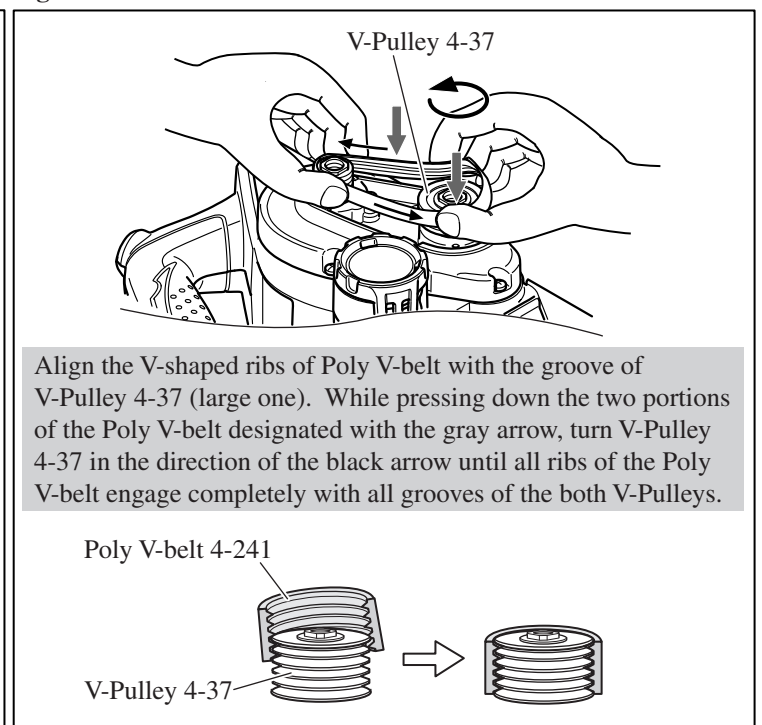

Fig. 6



► **Repair**

[3] DISASSEMBLY/ASSEMBLY

[3] -2. Motor Section

DISASSEMBLING

- 1) Remove Poly V-belt 4-241 as illustrated in **Fig. 2** to **Fig. 4**.
Note: Armature cannot be removed from Bracket complete until the Poly V-belt is removed from Pulleys.
- 2) Remove Rear cover by unscrewing two 4x18 Tapping screws. (**Fig. 7**)
 Then disconnect Carbon brushes from Commutator of Armature.
- 3) Put the machine on two 1R350's with Bracket complete side up. (refer to **Fig. 2**.)
 Unscrew four 4x18 Tapping screws that fasten bracket complete to Housing. (**Fig. 8**)
- 4) Remove Bracket complete together with Armature and Drum complete by levering off Bracket complete from Housing using two 1R263's. Duct assembly can be removed together with Nozzle. (**Fig. 9**)
- 5) Remove V-Pulley 4-20L from Armature shaft by turning **clockwise** with Wrench 13. (**Fig. 10**)
Important: Wear gloves to prevent injury to be caused by the sharp edge of Drum complete.
- 6) Armature can now be removed from Bracket complete by tapping Bracket complete with plastic hammer as illustrated in **Fig. 11**.

Fig. 7

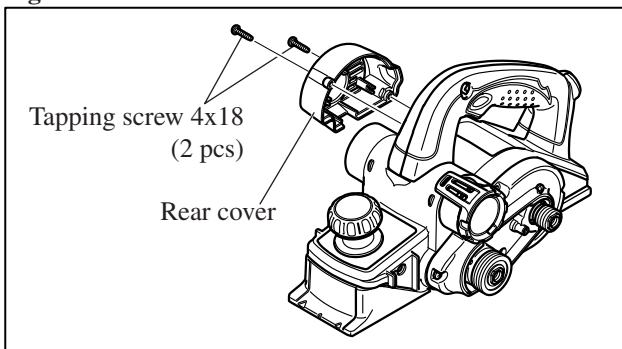

Fig. 8

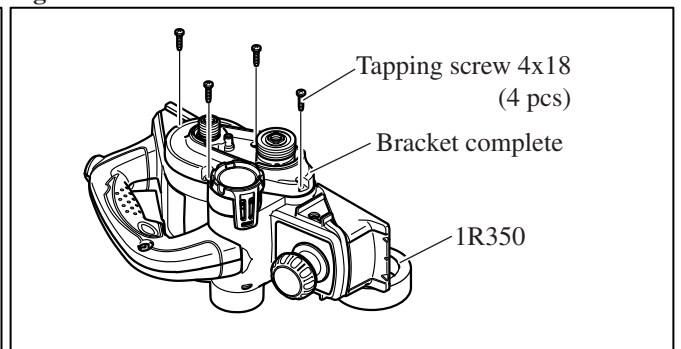

Fig. 9

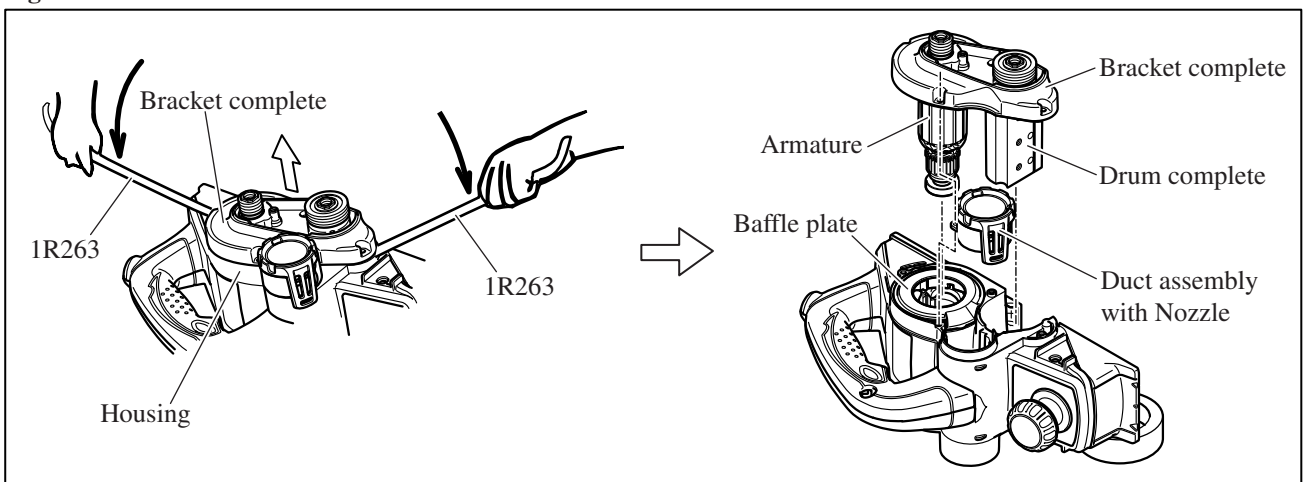

Fig. 10

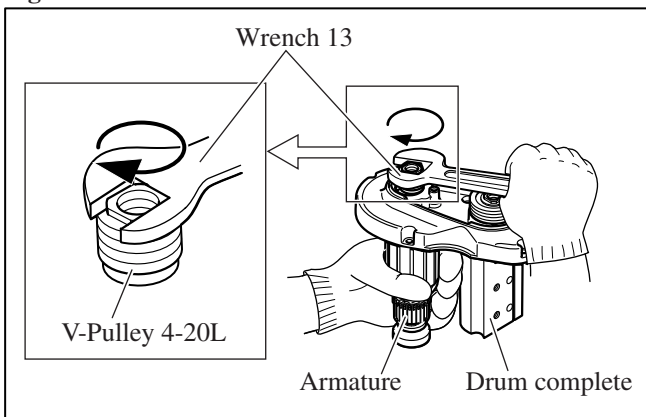
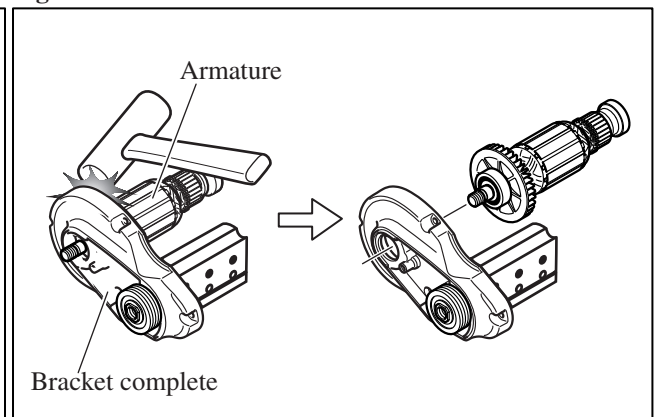

Fig. 11



ASSEMBLING

Do the reverse of the disassembling steps.

Note: Do not forget to assemble Baffle plate, duct assembly and Nozzle to Housing. (**Fig. 9**)

► **Repair**

[3] DISASSEMBLY/ASSEMBLY

[3] -3. Drum and Drum Holder Section

DISASSEMBLING

- 1) Remove Bracket complete from Housing as illustrated in Fig. 7 to Fig. 9.
- 2) Remove V-Pulley 4-37 from the shaft of Drum complete by turning **counterclockwise** with Wrench 13. (Fig. 12)
Important: Wear gloves to prevent injury to be caused by the sharp edge of Drum complete.
- 3) Remove Drum complete from Bracket complete using 1R045. (Fig. 13)

Fig. 12

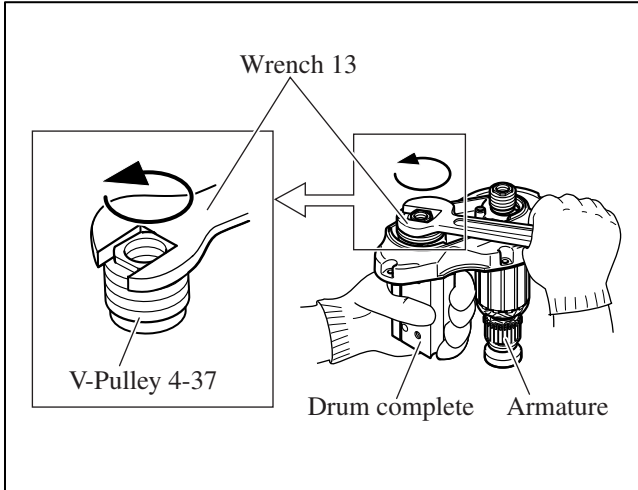
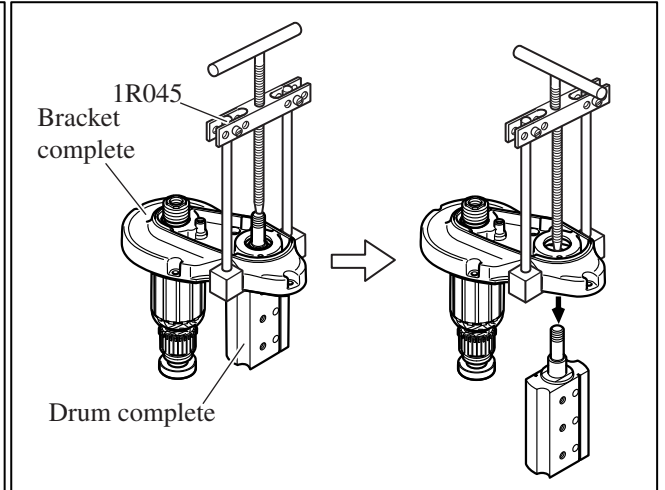

Fig. 13



- 4) Unscrew two M4x8 (+) screws that retain Ball bearing 6200DDW, then remove Ball bearing 6200DDW by tapping Bracket complete with plastic hammer as illustrated in Fig. 14.

Note: Ball bearing 6900LLB, which holds the shaft of drum complete on the opposite side to Ball bearing 6200DDW, remains assembled to Drum holder section to be disassembled in step 4) to 8).

- 5) By removing two 5x25 Tapping screws from the Rear cover side of Housing, Drum holder section can be disassembled as illustrated in Fig. 15.

Fig. 14

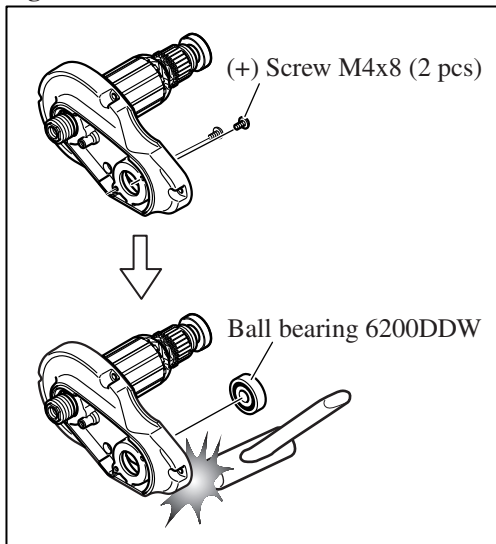
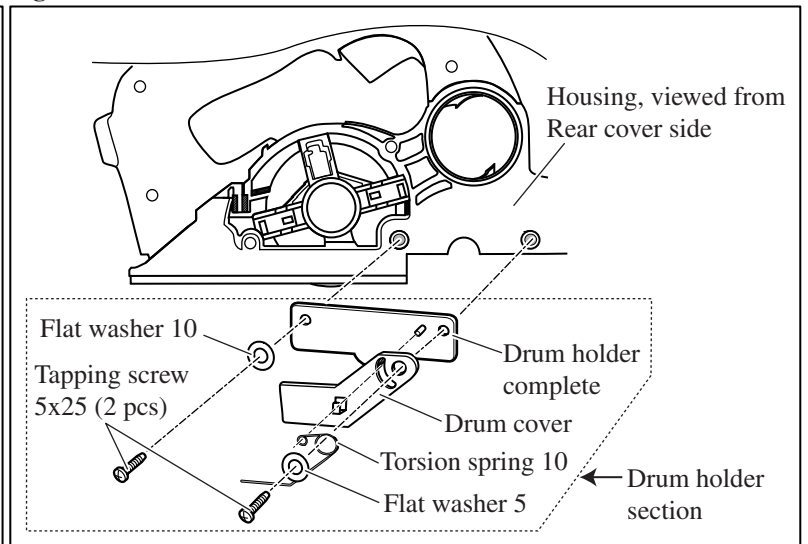

Fig. 15



- 6) Remove Retaining ring S-10 from Drum holder complete using 1R291. (Fig. 16)

- 7) Remove Ball bearing 6900LLB from Drum holder complete using 1R269. (Fig. 17)

- 8) Remove Flat washer 10 from Drum holder complete. (Fig. 18)

Fig. 16

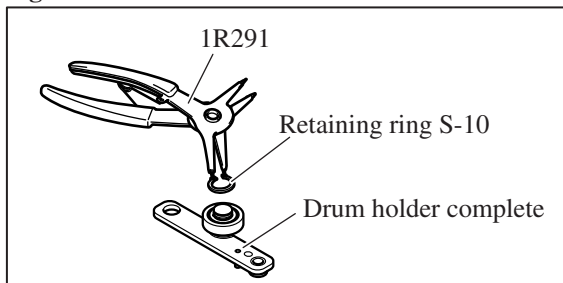

Fig. 17

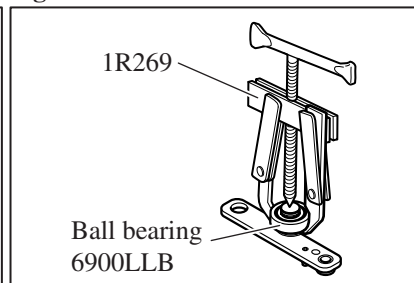
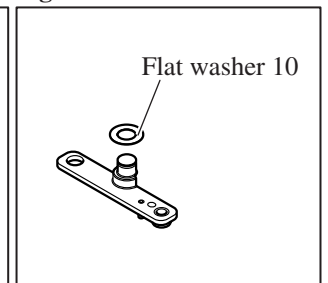

Fig. 18



► **Repair**

[3] DISASSEMBLY/ASSEMBLY

[3] -3. Drum and Drum Holder Section (cont.)

ASSEMBLING

1) Do the reverse of the disassembling steps 8) to 6). (Figs. 18 to 16)

Note: Do not forget to assemble Flat washer 10 to Drum holder complete as illustrated to **left** in Fig. 19 before assembling Ball bearing 6900LLB. Otherwise, Ball bearing 6900LLB cannot be assembled correctly to Drum holder complete as illustrated to **right** in Fig. 19.

2) Assemble Drum holder section to the Rear cover side of Housing as illustrated in Fig. 20.

3) Do the reverse of the disassembling steps 4) to 1). (Figs. 14 to 12)

Fig. 19

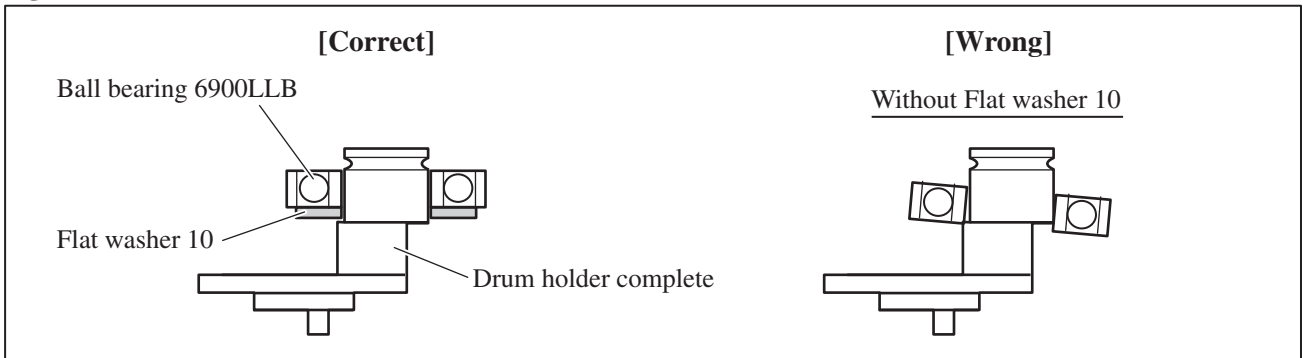
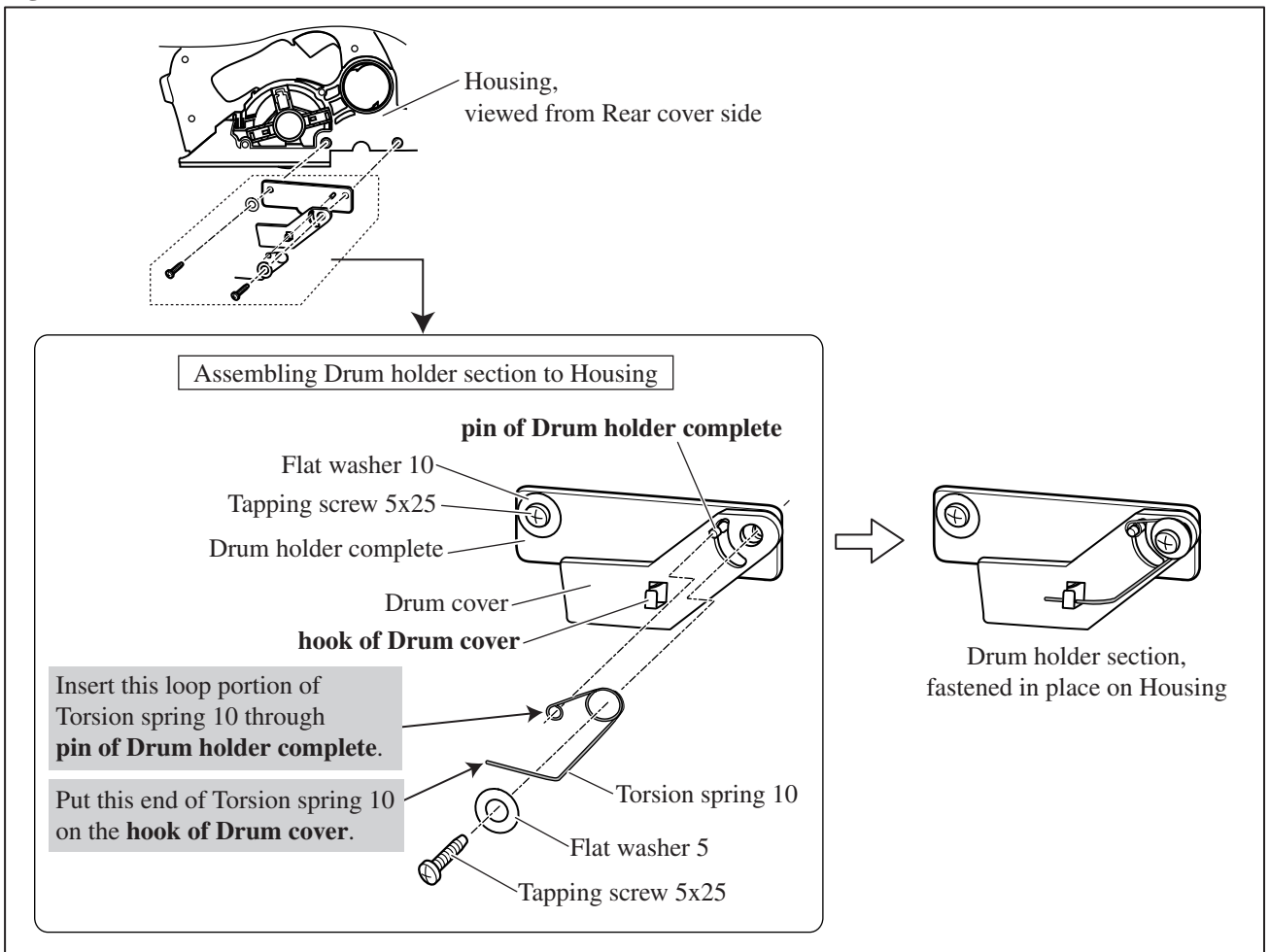

Fig. 20



► **Repair**

[3] DISASSEMBLY/ASSEMBLY

[3] -4. Front Base Section

DISASSEMBLING

- 1) Lever off Knob cover from Knob using a small slotted screwdriver. (Fig. 21)
- 2) Remove Knob from Cam by unscrewing Tapping screw 4x18. (Fig. 22)
- 3) Remove Steel ball 4 and Compression spring 3 with a screwdriver magnetized with 1R288. (Fig. 23)

Fig. 21

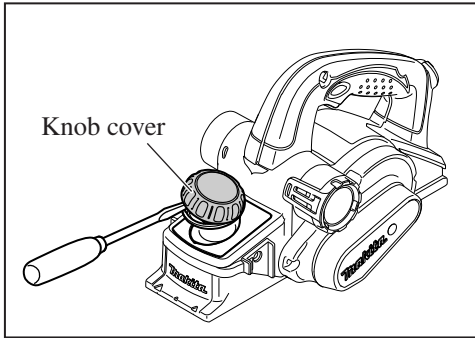

Fig. 22

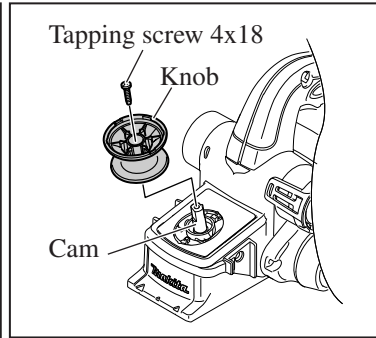
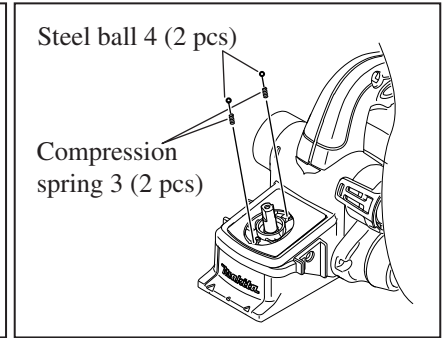

Fig. 23



- 4) Remove Front panel. And remove two Leaf springs by unscrewing two bind CT 4x12 Tapping screws. (Fig. 24)

Front base and Cam can now be removed from Housing. (Fig. 24)

ASSEMBLING

- 1) Apply Makita grease N. No.1 to the portions designated in Fig. 1 on page 2.
- 2) Insert Cam through the hole of Housing from the bottom side of Housing as illustrated in Fig. 25.
- 3) Assemble Front base to Cam, then provisionally install Front panel on Housing. (Fig. 26)
- 4) Adjust the position of the projected key portion of Cam as illustrated in Fig. 27.
- 5) Remove the Front panel provisionally installed, then secure Front base with Leaf spring and two bind CT 4x12 Tapping screws. (Refer to Fig. 24.)
- 6) Do the reverse of the disassembling steps 3) to 1). (Figs. 23, 22, 21)

Fig. 24

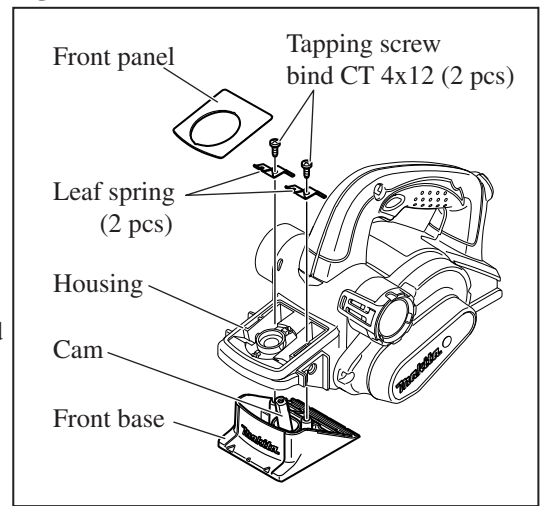

Fig. 25

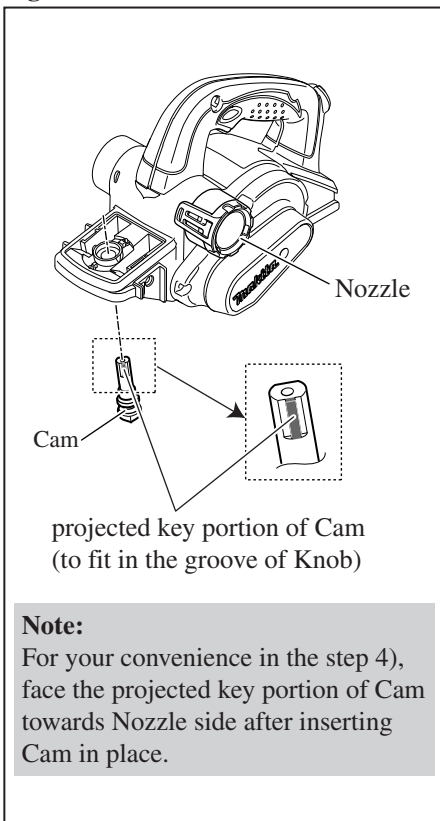

Fig. 26

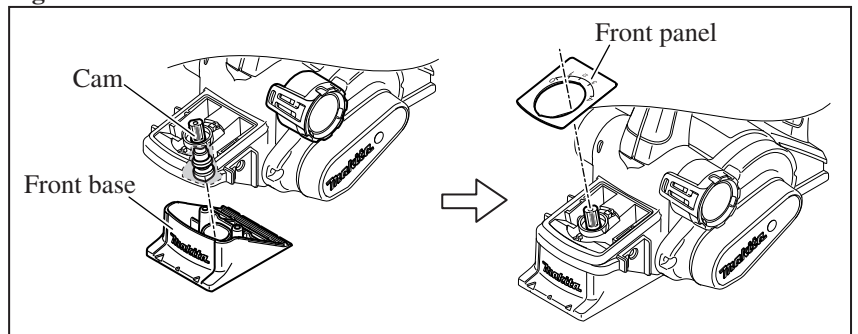
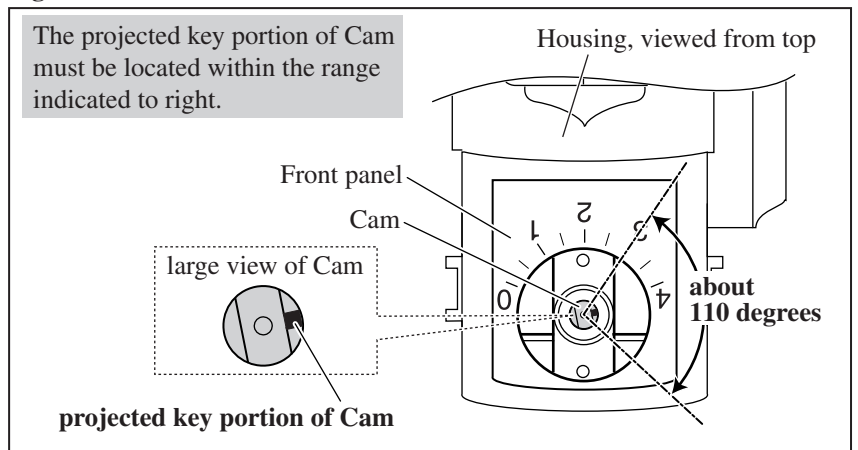

Fig. 27



► **Repair**

[3] DISASSEMBLY/ASSEMBLY

[3] -5. Base section

DISASSEMBLING

Base can be removed from Housing by unscrewing four 4x18 Tapping screws. (Fig. 28)

ASSEMBLING

Important: The edge of Base on Drum holder complete side must be exactly aligned with that of Front base.

- 1) Place a ruler against the edge of Front base on Drum holder complete side. (Fig. 28)
- 2) Fasten four 4x18 Tapping screws while making sure that the ruler is exactly square against Front base and Base. (Fig. 28)

Fig. 28

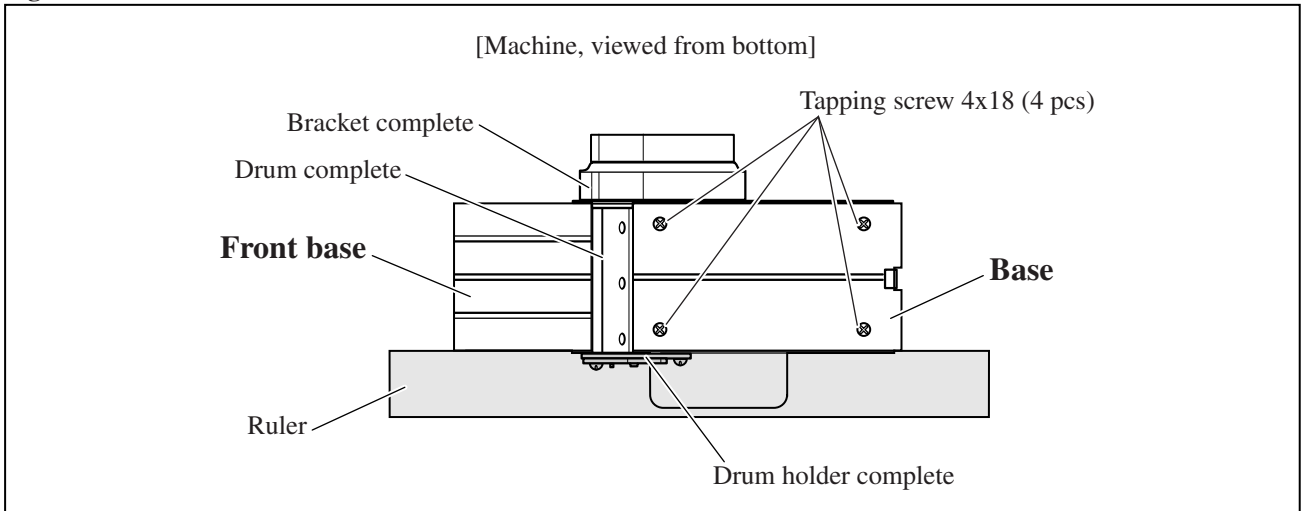

[3] -6. Planer Blade

Install Planer blades as illustrated in Fig. 29. Fig. 29

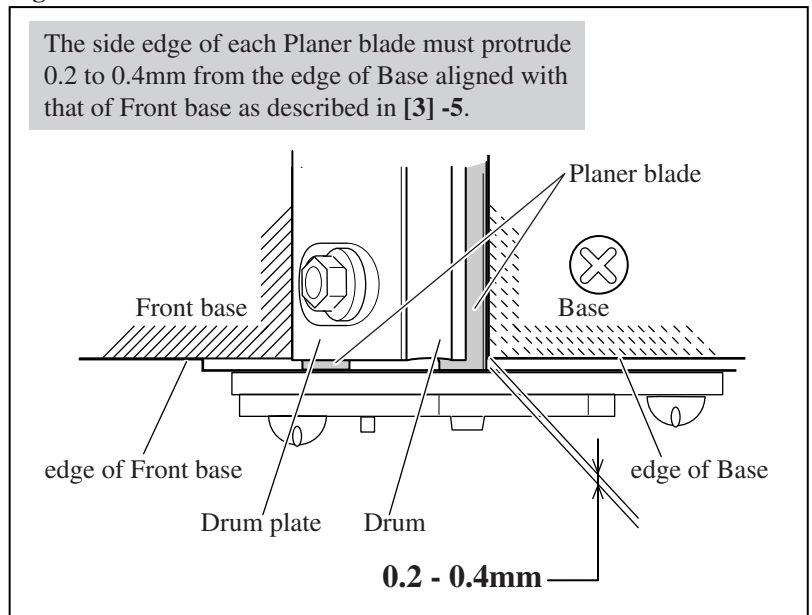

► **Repair**

[3] DISASSEMBLY/ASSEMBLY

[3] -7. Electrical Parts in Handle Section

DISASSEMBLING

For replacing the electrical parts in Handle section;

- 1) Remove Rear cover by unscrewing two 4x18 Tapping screws. (Fig. 30)

Note: It is impossible to remove Handle (R) from Handle (L) without removing Rear cover.

- 2) Remove Handle (R) from Handle (L) by unscrewing five 4x18 Tapping screws as illustrated to left in Fig. 31.

Now the electrical parts illustrated to right in Fig. 31 can be removed from Housing (L).

Fig. 30

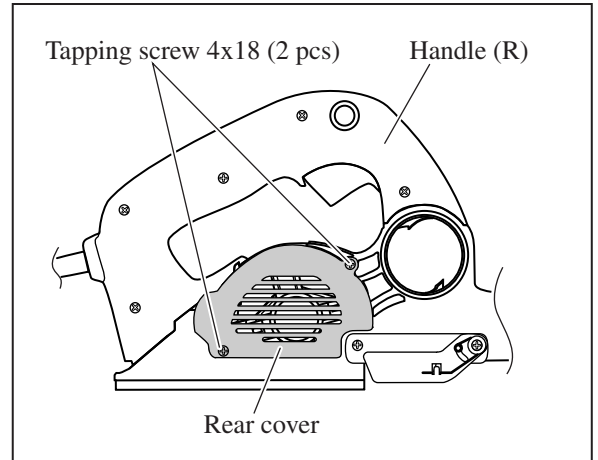
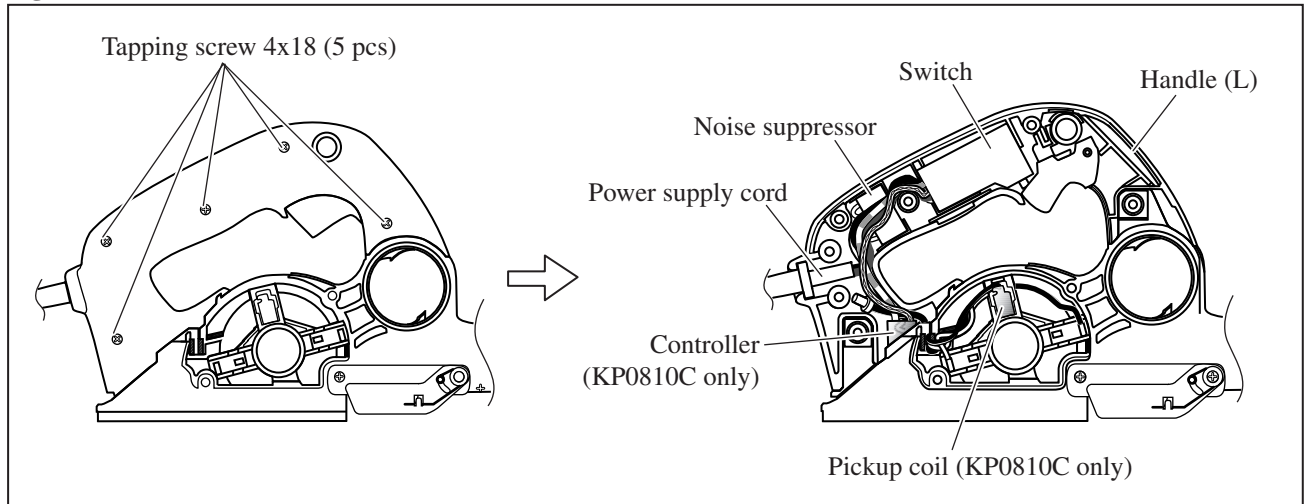
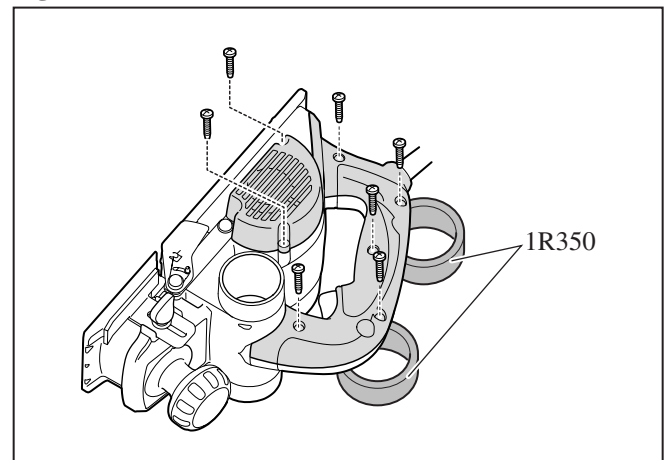

Fig. 31



Note: If it is difficult to remove screws, put the machine on two 1R350's as illustrated in Fig. 32.

Fig. 32



► **Circuit diagram**

KP0810

Fig. D-1

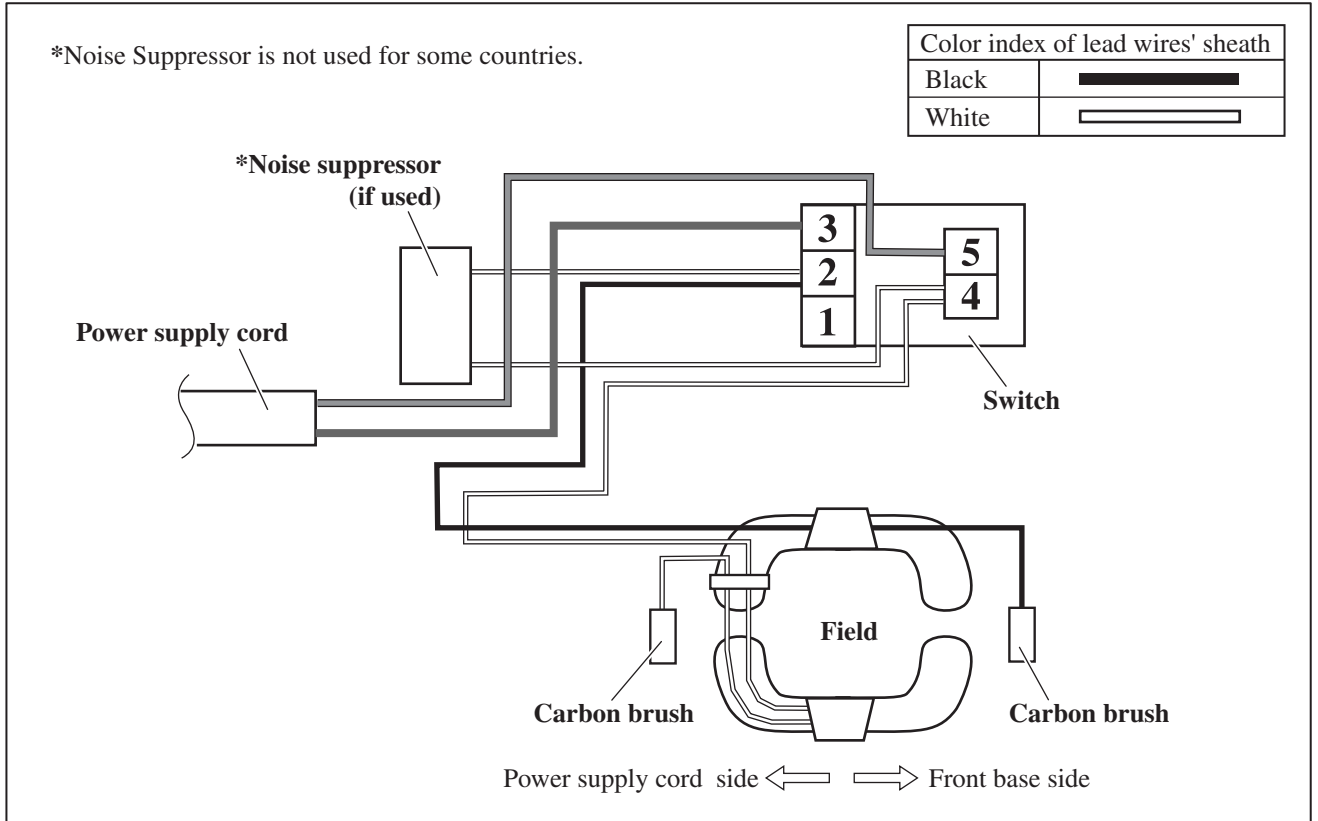

KP0810C

Fig. D-2

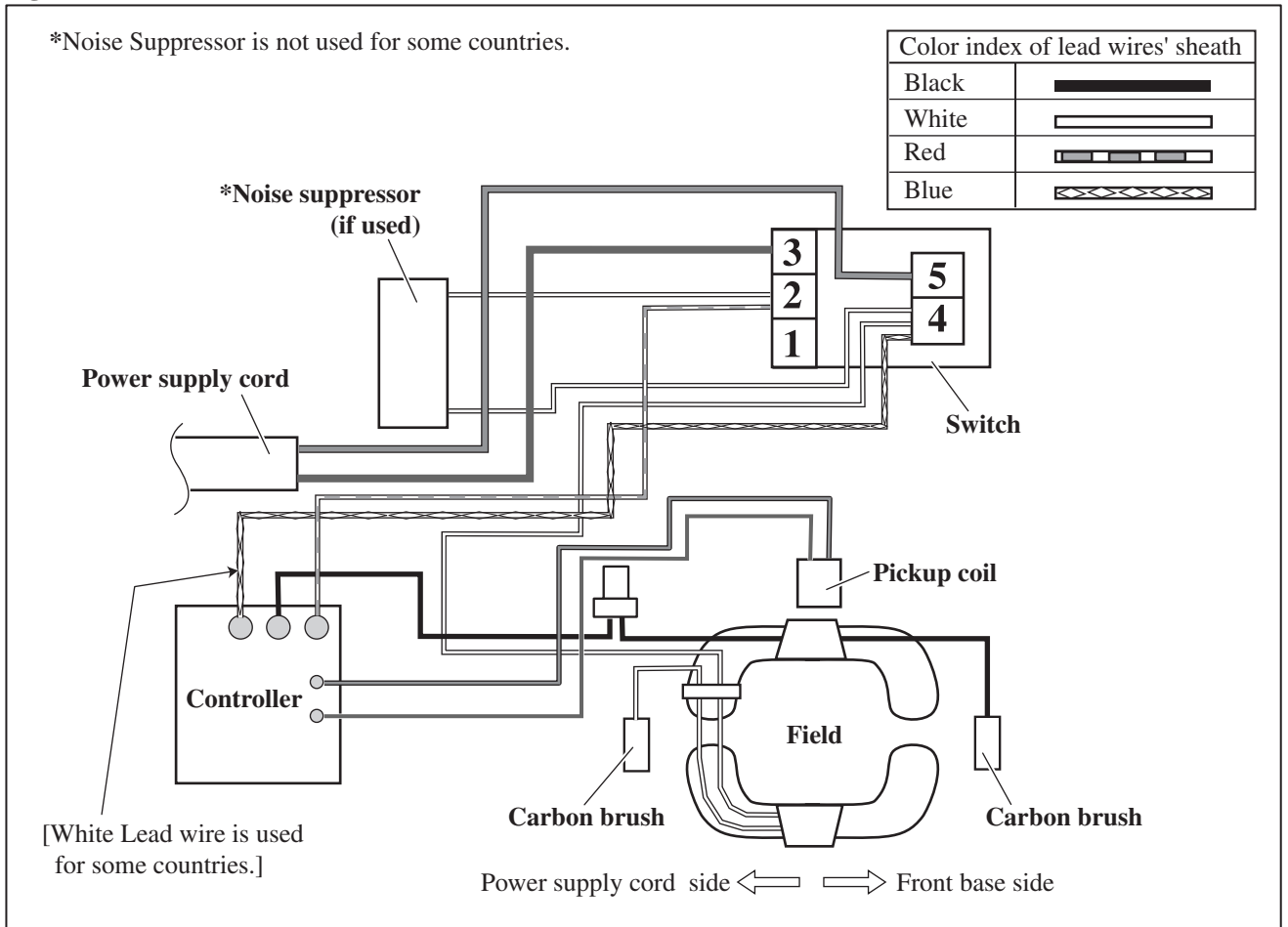

▶ **Wiring diagram**

KP0810

Fig. D-3

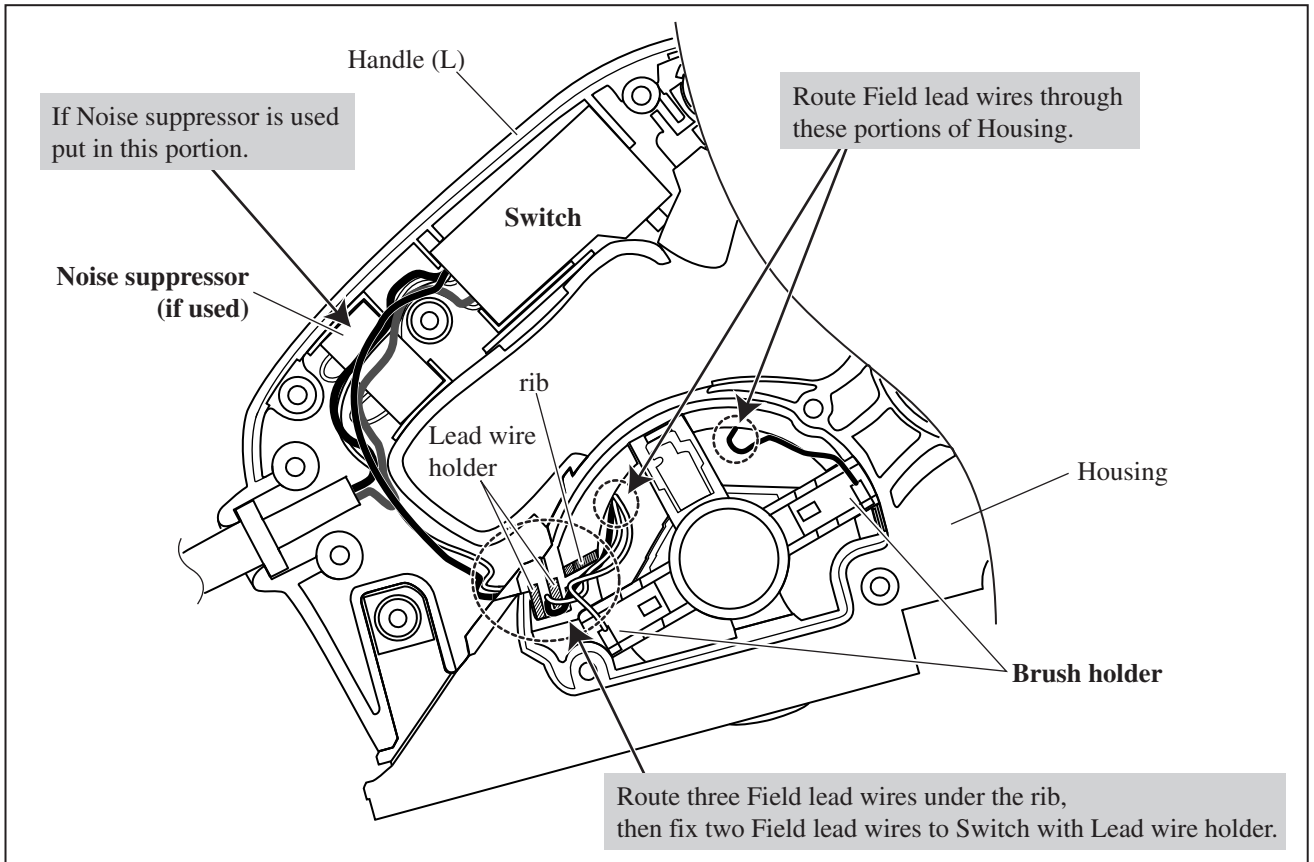

KP0810C

Fig. D-4

